

SW2015

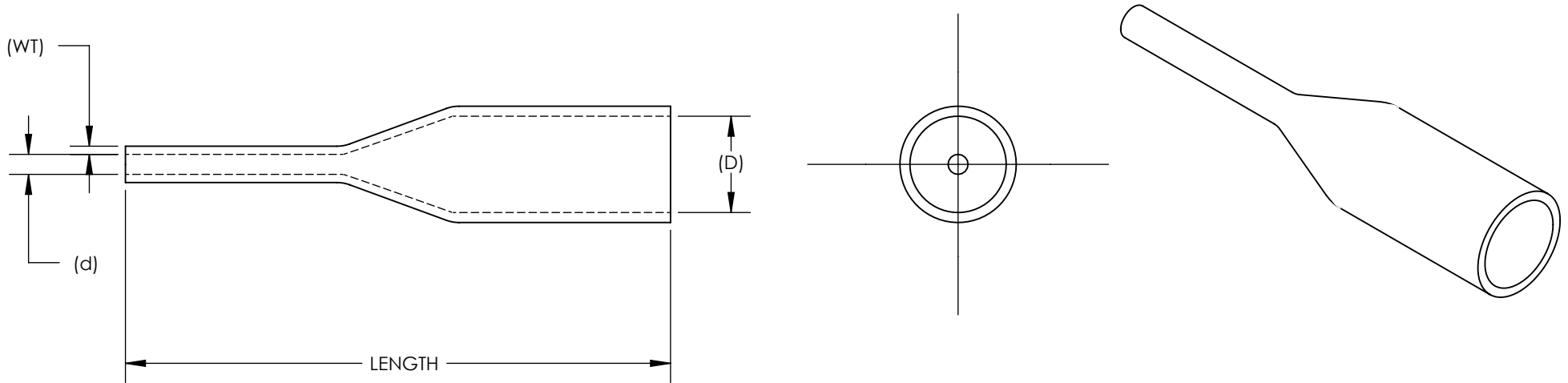

Revision level			Revision Record	Changed	Date	Approved	Date
Drawing	State	Part					
01.1	Design Release		SEE ECN# 014399	CAS	4/17/2018	KAC	4/17/2018



01.1

- NOTES:**
1. SHRINK RATIO 3:1
 2. LONGITUNDINAL CHANGE AFTER SHRINKAGE +5%
 3. MINIMUM SHRINK TEMPERATURE 212 F
 4. OPERATING TEMPERATURES -67 F TO 275 F
 5. DIELECTRIC STRENGTH >20KV/MM ACCORDING TO ASTM D 150
 6. FLAMMABILITY UL 224 VW-1 600V (except clear)
 7. STANDARDS - MEETS SAE-AMS-DTL-23053/5 CLASS 1 & 3

Type	Shrink Ratio	Nominal Size	Supplied Diameter (D)		Recovered Diameter (d)		Wall Thickness Recovered (WT)		Color	Length		Quantity per Pack
		in	in	mm	in	mm	in	mm		in	mm	
Hangtag Packs: 3:1 Thin Wall												
HIS-3-BAG-3/1 BK	3:1	1/8	0.13	3.2	0.039	1.0	0.022	0.55	Black	6	153	10
HIS-3-BAG-4.5/1.5 BK	3:1	3/16	0.19	4.8	0.059	1.5	0.024	0.60	Black	6	153	10
HIS-3-BAG-6/2 BK	3:1	1/4	0.25	6.4	0.079	2.0	0.026	0.65	Black	6	153	10
HIS-3-BAG-9/3 BK	3:1	3/8	0.38	9.5	0.118	3.0	0.029	0.75	Black	6	153	10
HIS-3-BAG-12/4 BK	3:1	1/2	0.50	12.7	0.157	4.0	0.031	0.80	Black	6	153	10
HIS-3-BAG-3/1 CL	3:1	1/8	0.13	3.2	0.039	1.0	0.022	0.55	Clear	6	153	10
HIS-3-BAG-4.5/1.5 CL	3:1	3/16	0.19	4.8	0.059	1.5	0.024	0.60	Clear	6	153	10
HIS-3-BAG-6/2 CL	3:1	1/4	0.25	6.4	0.079	2.0	0.026	0.65	Clear	6	153	10
HIS-3-BAG-9/3 CL	3:1	3/8	0.38	9.5	0.118	3.0	0.029	0.75	Clear	6	153	10
HIS-3-BAG-12/4 CL	3:1	1/2	0.50	12.7	0.157	4.0	0.031	0.80	Clear	6	153	10

Material
POLYOLEFIN, CROSS LINKED

Units: **millimeters**
Dimension without tolerances details to:
.xxx = ±.013
.xx = ±.13
.x = ±.3
None = ±.8
∠ = ±0.5°
Dimension Formatted mm/[in]

The copyright of this drawing is reserved by HellermannTyton. It is issued on condition that it is not reproduced, copied, or disclosed to a third party, either wholly or in part, without the consent of HellermannTyton.

Drawn GRW 12/9/2016
Approved KAC 12/9/2016

HellermannTyton
North America
Email: corp@htamericas.com
Web: www.hellermann.tyton.com

Article/Type-No TFN31 HIS-3 BAGS
Title **HEAT SHRINK TUBING, 3:1 SHRINK RATIO, NON-ADHESIVE THIN WALL**
Drawing-No PRODUCTION : Phase
16-1992-001-CSU

Scale
Project Number PRP 16-1992
Format AH
Sheet 1/1