

26. Align the sealing nut pins with the sealing port so pins can slide over the well.

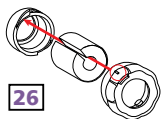

27. Using force, compress the sealing grommet and rotate the sealing nut clockwise to secure in place.



28. When installed properly, nut will sit evenly and not rotate.

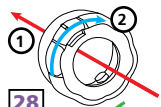

29. Inspect the sealing grommet to ensure it is captured entirely within the sealing port.



If an edge is exposed through the nut, remove nut and reinstall, ensuring the entire sealing grommet is captured.

Drop Cable Installation

30. Remove sealing nut and grommet from CCP if previously installed.



31. Insert terminated drop cable connector through the sealing nut, entering smaller hole first.



32. Insert the drop cable plug through the sealing port.



33. Clean endface and install the drop cable plug into the adapter, ensuring the connector is fully mated.



34. Detach the sealing plug from the side of the sealing grommet.



35. Wipe the entire surface (inside and outside) of the sealing grommet with the disposable lubricating wipe.



36. Install sealing grommet over the drop cable near the sealing port and push until it seats.

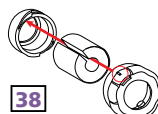

37. Slide the sealing nut up to the sealing grommet.

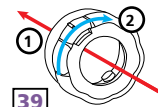

38. Align the sealing nut pins with the housing sealing port so pins can slide over the port.

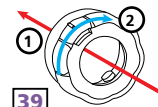

39. Using force, compress the sealing grommet and turn the sealing nut to secure in place.

40. Inspect the sealing grommet to ensure it is captured entirely within the sealing port.



If an edge is exposed through the nut, remove nut and reinstall, ensuring the entire sealing grommet is captured.



Housing Seal Cover Installation

41. Align the CCP cover with the CCP Housing, ensuring all fibers are safely enclosed within the housing and are not being pinched.



42. Using hand pressure only, press the cover onto the housing to secure in place.

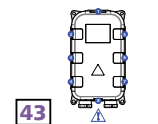

43. Each latch will snap into place with a "click" when secure.



44. Visually check each of the eight latches to ensure they are fully seated and secure to prevent moisture ingress.



INSTALLATION GUIDE

1. Remove cover by releasing the side latches.
2. Verify all components are supplied:
 - Disposable lubricating cloth
 - Quarter-turn sealing nuts
 - Sealing grommet with attached sealing plug (DO NOT discard plug)
 - Adhesive disk



Premise Cable Installation

3. Remove 700 mm [27.5"] of outer jacket of premise cable. Trim Kevlar to 50 mm (2").
4. Feed cable through quarter-turn sealing nut (larger opening toward the enclosure).

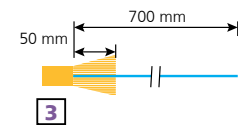

- 5. Feed premise cable through sealing port. Secure cable to CCP housing using supplied screw.



- 6. Press cable into holding feature located in the bottom of the housing.



- 7. Remove sealing plug from sealing grommet.



Wipe the entire surface (inside and outside) of one sealing grommet with the disposable lubricating wipe.

- 8. Install sealing grommet over the premise cable near the sealing port and push it into the sealing port until it seats.



- 9. Slide the sealing nut up to the sealing grommet.



- 10. Align the sealing nut pins with the housing sealing well so pins can slide over the port.

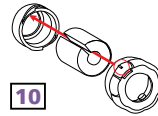

- 11. Using force, compress the sealing grommet and rotate the sealing nut clockwise to secure in place.

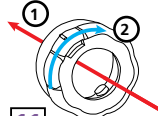

- 12. When installed properly, nut will sit evenly and not rotate.



- 13. Inspect the sealing grommet to ensure it is captured entirely within the sealing port.

If an edge is exposed through the nut, remove nut and reinstall, ensuring the entire sealing grommet is captured.



Premise Cable

- 14a. If fusion splicing directly to drop cable (no connector or adapter used) – skip to step 30 and fusion splice after cable is routed through sealing port.

- 14b. If using a field terminated connector (no splicing) - Install field terminated connector to the end of the premise cable.

- 15. Clean the endface of the connector, then plug into the optical adapter. Install the connector/adapter into the mounting position, aligning the short adapter flanges within the mounting rails as shown.



- 16. Continue to route the pigtail fiber as shown around the mounting guides. Fiber should route over the installed premise cable and through the slotted guide by the left sealing port.

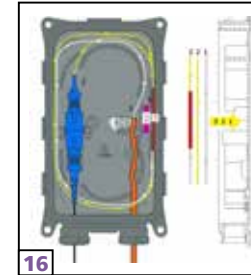

- 17. Route premise fiber in the opposite direction around the routing guides.

- 18. Splice fibers together.

- 19. Install fusion splice into the fusion splice holder along the side of the housing.

- 20. Complete routing of the remaining fiber, ensuring it sits within the tray.

Connector/Pigtail Installation

- 21. Ensure fibers are routed within the slot, then place adhesive disk over slotted cable guide near drop cable entrance port to secure fibers.



Fibers should be free moving and not bind when disc is attached.

Sealing Grommet Installation for Unused Port

- 22. If CCP will not have drop cable immediately installed, a sealing plug should be installed into the unused port to protect against moisture, dirt and insects.



- 23. Detach the sealing plug from the side of the sealing grommet. DO NOT discard.



- 24. Wipe the entire surfaces (inside and outside) of the sealing grommet and sealing plug with the disposable lubricating wipe.



- 25. Insert the sealing plug into the sealing grommet, then insert assembly into the sealing port with the point of the plug facing out.

